

BASEMENT WATERPROOFING SOLUTIONS





Steve Andras, CWS,CSRS
Chief Executive Officer
GrateProducts LLC

Our Beginings

In 2006 Steve and his team begin work on his greatest invention, the GrateDrain System. The GrateDrain along with GrateSump and GrateTrench have changed the way basement drainage is being done. Steve pioneered the idea of closed drainage systems. He informed his local company in August 2006 that Pioneer Basement would only install closed drainage systems.

In late 2006 Grate Products, LLC was founded to distribute quality basement drainage products and train Authorized Contractors throughout the world as to properly installing them.

Today, Steve continues to help people make their basements healthy. Steve has served as President of the National Association of Waterproofing & Structural Repair Contractors (NAWSRC) in 2000-2002 and President of the Basement Health Association (BHA) in 2010-2011. He is currently serving as the Education Committee Chairman of the Basement Health Association. With his leadership he is helping create a new an exciting industry which has the potential of improving the quality of life of millions of people - Basement Health.

Finally all the service trades working in the basement environment will be talking and sharing together for the benefit of all consumers.



Choice & Control

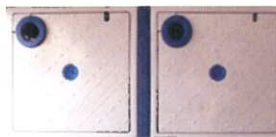

Mission

Grate Products, LLC purpose is to protect people from the dangerous conditions that can exist in their basement, by providing our quality basement products and processes. Our goal is to make every home in the world healthier by helping our contractors provide their clients with products & services that promote a healthy basement environment.

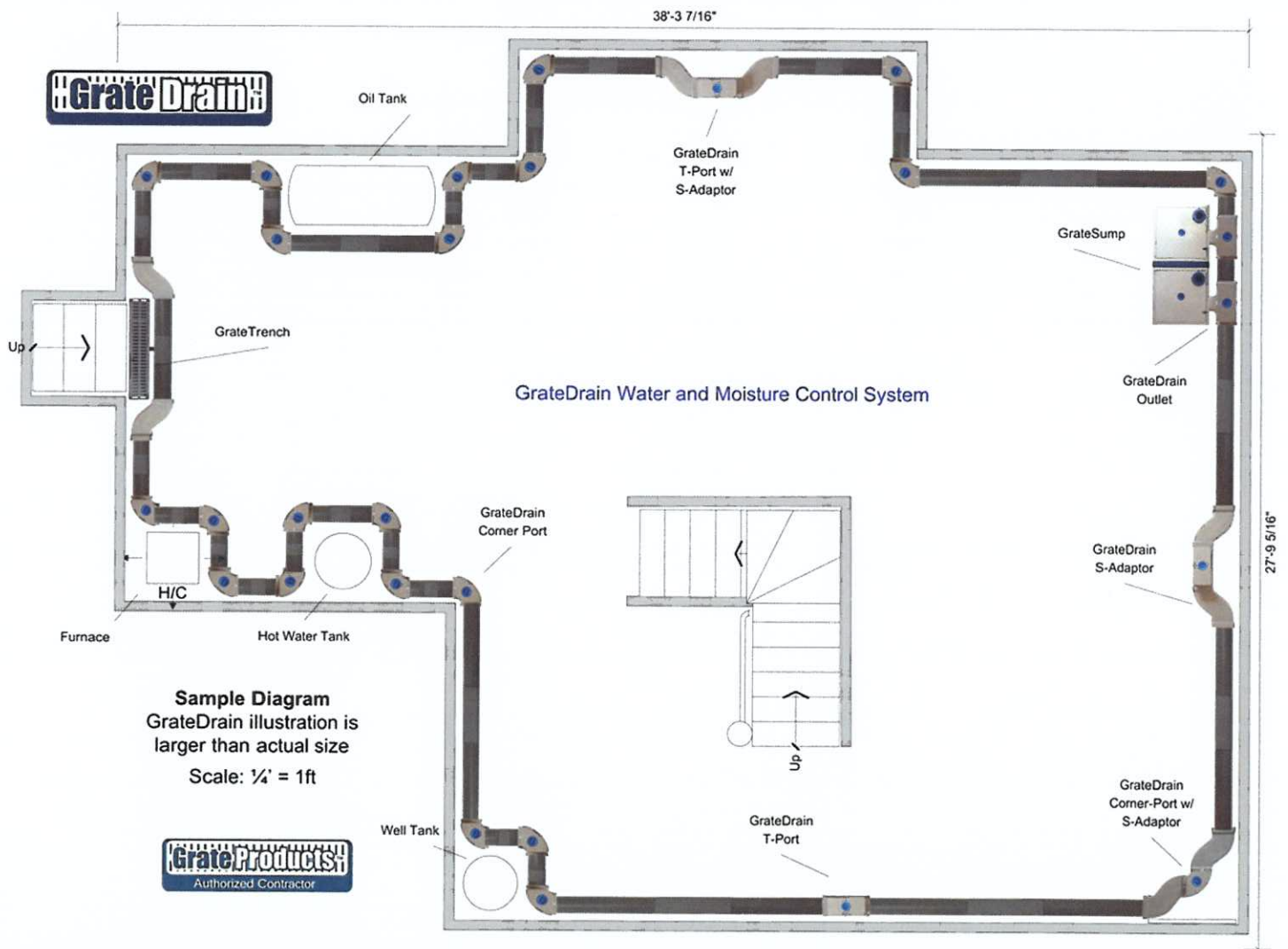

Grate Drain™

GrateDrain is an engineered sub floor basement drainage system used to quickly channel ground water to a collection system (GrateSump) where it can be pumped away. GrateDrain is designed so that its large punched holes on both sides collect ground water rapidly. It has many engineered fittings with access ports for the ability to maintain the system.

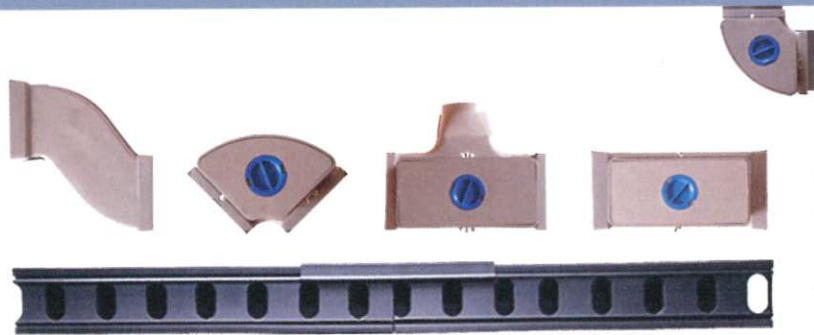

Patent No: US 7,945,289 B2

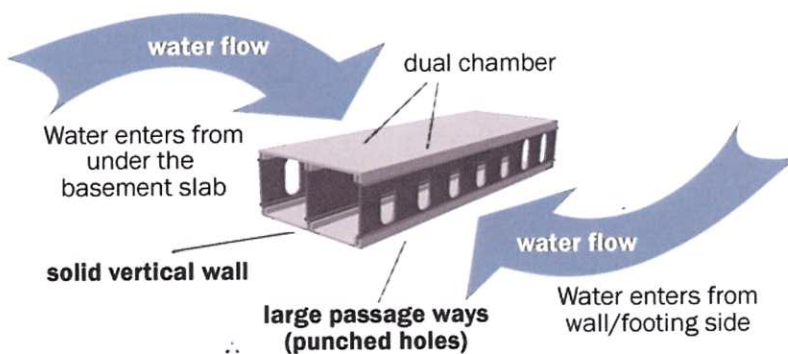

Closed System (sealed system)



Dehumidifier plug
Allows drain for dehumidifier



Easy access for servicing
All ports can be accessed for a system flush.

Contoured design
Does not promote clogging

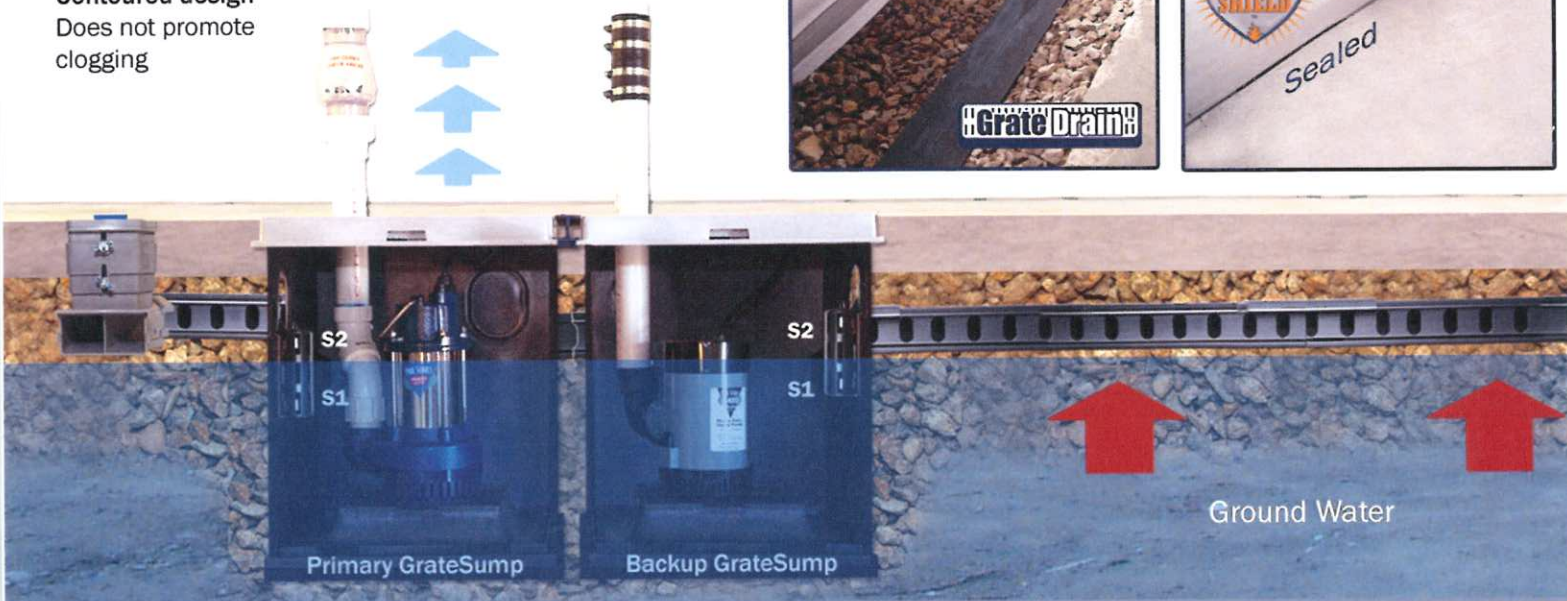

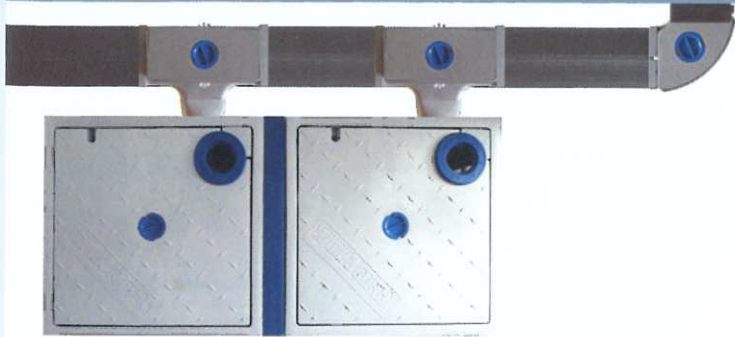

GrateDrain Features

- GrateDrain is custom built for every basement
- GrateDrain has a dual chamber design. Water can enter from the wall/footing seam and from under the basement.
- Isolate iron bacteria colonies
- Easy cover and panel access for system flush
- Engineered drainage system that offers more value
- GrateDrain is the strongest system on the market

One of the many benefits to the GrateDrain system is that it is a closed system (sealed system). Any water, or ground humidity it collects cannot evaporate back into the home environment.

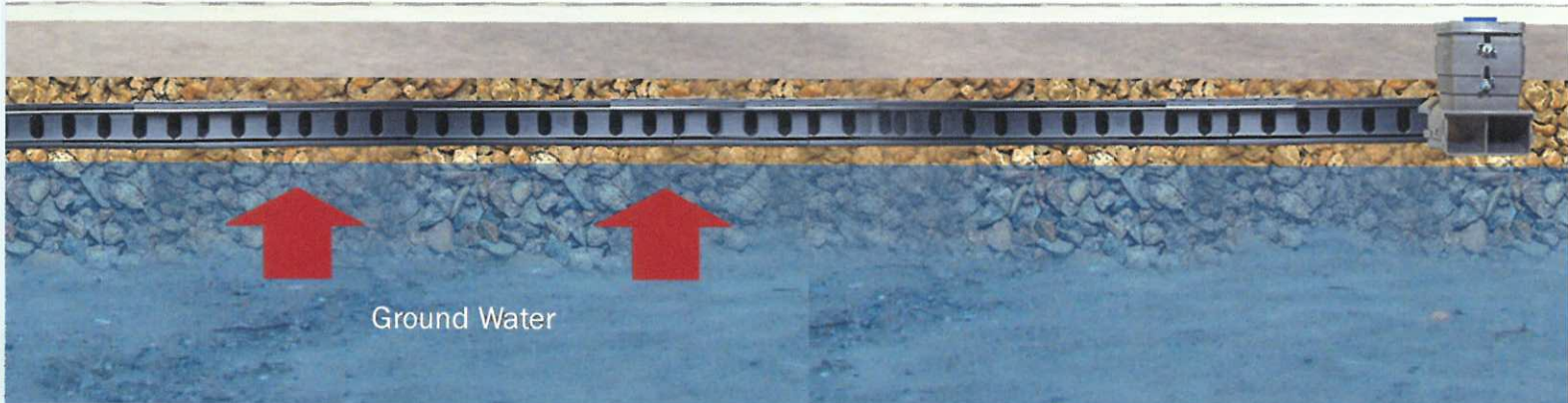
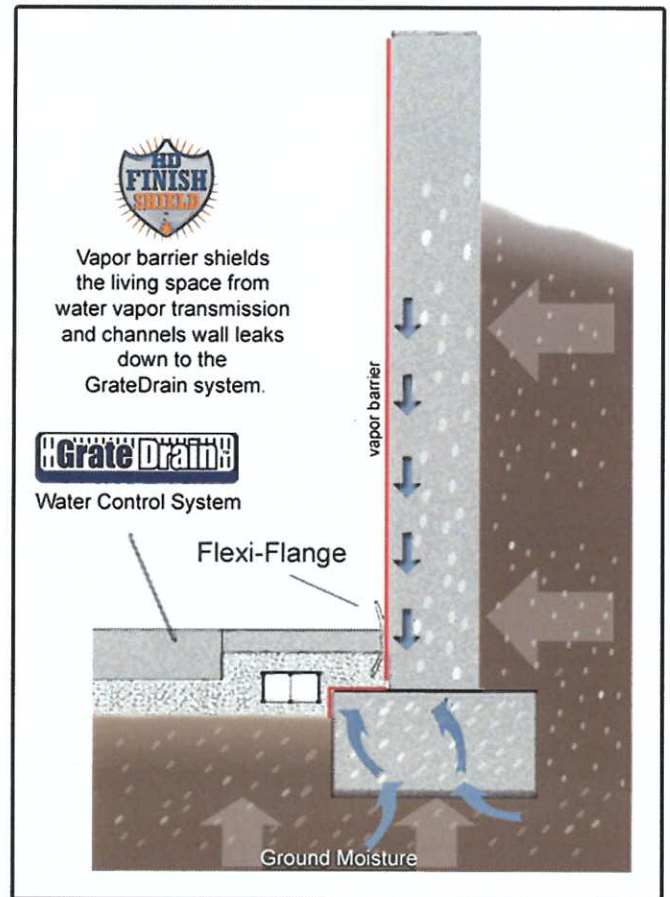

Sump Pump & Battery Backup Systems

Featured Products



Patent No: US 7,788,877 B2



GrateSump is an engineered sump pump housing that is designed to quickly remove water from under a basement floor.

The GrateSump includes features that ensure unmatched performance and reliability.

- Does not promote undermining of the foundation.
- GrateSump resists iron & clogging.
- Built in pump stand.
- Dehumidifier drain plug.
- Virtually air tight cover.



FastSump Pump

- 1/3 HP Sump Pump
- 2400 GPH
- Permanent Split Capacitor
- Reliable Float Switch w/ bypass switch
- Energy Efficient (Only 4amps)
- Durable Cast Iron
- 3yr Warranty



GrateSump Plus (2400GPH)

- Primary Sump Pump System with Battery Backup
- 2400GPH with AC or DC Power
- (1) GrateSump - Advanced Sump Pump Liner
- (1) FastSump Pump - 1/3HP Sump Pump
- (1) FS-900 Power Inverter
- 900w Inverter converts 12v DC to 115v AC
- (1) Sealed Battery - 100AH



GrateSump Plus (Combo)

- Dual Primary Sump Pump System with (1) Battery Backup
- 4800GPH with AC Power
- 2400GPH with DC Power (Battery Backup)
- (2) GrateSump - Advanced Sump Pump Liner
- (2) FastSump Pump - 1/3HP Sump Pump
- (1) FS-900 Power Inverter
- 900w Inverter converts 12v DC to 115v AC
- (1) Sealed Battery - 100AH

Dehumidification & Wall Protection

Featured Products

Tested & Certified

Fire Rating: Class A

Low Water Vapor Permeance

Moisture Control

Dehumidification For Basements



(High Efficiency, High Capacity)

WiseAire¹⁰⁰

- Removes 100 pints/ day
- Up to 3200 square Feet
- Blower: 280 CFM @ 0.0" w.c
- Current Draw: 6.9amp
- Inlet or Outlet Ducting
- Made for Basements and Crawl Spaces
- Digital Display
- Gravity Drain System
- 5yr limited warranty
- Auto Restart

Vapor Barrier



Low permeability vapor barrier in conjunction with the sealed GrateDrain System protects the basement against moisture. Lorem Ipsum



HD FinishShield™- HD FinishShield is a 16mil, Class A (Fire Rated) wall vapor barrier. Recommended as a durable wall covering. It is perfect for basement walls where a customer may not finish right away, but would like the protection against moisture, mold, mildew, humidity, and potential wall leaks. The measured average permeance of FinishShield is 0.015 perm.



ThermalShield™- ThermalShield is a 90mil Class A (Fire Rated) foil faced true white poly wall vapor barrier. It is the wall vapor barrier of choice for reflecting indoor heat back into the basement space. Save energy and protect against moisture, mold, mildew, humidity, and potential wall leaks. The measured average permeance of ThermalShield is 0.014 perm.



(High Efficiency, High Capacity)

WiseAire⁷⁰

- Removes 70 pints/ day
- Up to 2800 Cubic Feet
- Blower: 200 CFM @ 0.0" S.P.
- Current draw: 5.8amp
- Temp. Controlled Defrost
- Inlet or Outlet Ducting
- Made for Basements and Crawl Spaces
- Energy Star® Listed
- Digital Display
- Auto Restart
- Gravity Drain System
- 5yr limited warranty

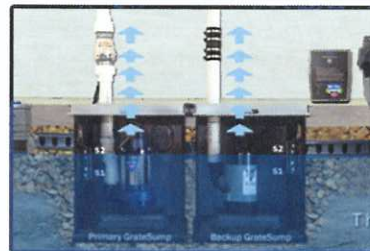

Leaky Bulkhead?

GrateTrench solves your water problems by redirecting leaks into a pre-sloped trench. Water is then channeled through an air resistant valve and drained to your sump.

Industry Exclusive Closed (Sealed) Trench Drain



GrateTrench Features

- ✓ Ideal for bulkheads, sliding doors, & exterior doorways
- ✓ Can be used around hot water tanks & overflow water pipes
- ✓ Pre-sloped trench, no stagnant water smells
- ✓ Closed system -air resistant valve
- ✓ Available 1ft. kits or 4ft. kits and has options to extend to any length.



Water, moisture, and ground humidity can not evaporate back into the home.



www.GrateProducts.com

Copyright © 2016 by Grate Products, LLC

All rights reserved. This publication or any portion thereof may not be reproduced or used in any manner whatsoever without the express written permission of Grate Products, LLC.



1-866-279-2837
www.GrateProducts.com